

Project By:

RERA No.: RAJ/P/2025/3912
RERA No.: RAJ/P/2025/3780

Marketed By:



Bhumija Empire - 1st Empire - 1st



AT VILLAGE - KHORASHAYMDAS, TEH. RAMPURA DABARI, JAIPUR

ABOUT US

Bhumija Group is a well-established, experienced and renowned name in the field of land developers in Rajasthan. Our focus is on building lasting relationships and delivering excellence in style, quality and substance. Bhumija Group is the name of determination and faith which is continuously creating records in the the field of real estate through the use of new technology and innovation. Bhumija Group's strong team with a commitment and vision also plans to give comprehensive solutions to the people in terms of townships development. Bhumija group prepares all the projects keeping in mind the present and future needs of the people and upcoming engineering in the most appropriate manner.

SOME OF OUR COMPLETED PROJECTS

- BHUMIJA ALANKAR 4th
- BHUMIJA ALANKAR 2nd & 3rd
- BHUMIJA ALANKAR MAIN
- BHUMIJA ALANKAR FIRST
- BHUMIJA PRAGAN BLOCK A
- BHUMIJA PRAGAN BLOCK B
- BHUMIJA ARPAN
- ROYAL BHUMIJA
- BHUMIJA PRAGAN
- THE PARK ROYAL
- BHUMIJA PRIME BLOCK-C
- BHUMIJA PRIME
- BHUMIJA RESIDENCY
- ABHIMANYU RESIDENCY

CONNECTIVITY

WEEKEND POINTS

- ▶ Chop Stadium 3 KM
- ▶ Angel Resorts 5.6 KM
- ▶ Eden Garden 5.6 KM
- ▶ Mauj Mahal 7.1 KM

EDUCATION

- ▶ Bright Moon School 1 KM
- ▶ Bharat Law College 8.5 KM
- ▶ N.K.Public School 9.5 KM
- ▶ Imperial Nursing College 12 KM

HEALTH CARE

- ▶ Chirayu Hospital 5.5 KM
- ▶ S.K.Hospital 9 KM
- ▶ Shreeji Hospital 12 KM
- ▶ Deepak Gupta Hospital 12 KM
- ▶ Barala Hospital 13 KM
- ▶ K.R.Hospital 13 KM
- ▶ CKS Hospital 14.4 KM
- ▶ Manipal Hospital 15.4 KM

PROMINENT ROUTES

- ▶ Rajawas 5 KM
- ▶ Tantiawas Toll Plaza 6 KM
- ▶ Sun City 6 KM
- ▶ Delhi By Pass 6.9 KM
- ▶ Nindra Mod 11 KM
- ▶ Chomu By Pass 12.5 KM
- ▶ 14 No. Road 12.6 KM
- ▶ Chomu Pulia 19 KM
- ▶ Sindhi Camp Bus Stand 24 KM
- ▶ Jaipur Railway Station 25 KM

Introducing a residential masterpiece inspired by Europe's rich architectural heritage. This project offers a rare opportunity to own a home that combines cultural richness with modern amenities, making it perfect for those who appreciate both heritage and innovation.



Lifestyle Comforts

- ▶ Shopping Arcades
- ▶ GYM Area
- ▶ Planter sittings
- ▶ Feature Wall & Sculpture

Iconic European Charm

- ▶ Grand Entry Gate
- ▶ Iconic European sculptures
- ▶ Beautifully designed arches
- ▶ Classic streetlights

Smart Infrastructure

- ▶ Underground Water Line
- ▶ Underground Electrification
- ▶ Underground Sewage Line
- ▶ Wide Paver Roads

Eco-Friendly Features

- ▶ Solar-Light
- ▶ Plantation
- ▶ Breathtaking Landscapes
- ▶ Non-Toxic Paints & Finishes



Bhumija Empire -1st **Empire -1st**

DEVELOPED PARK

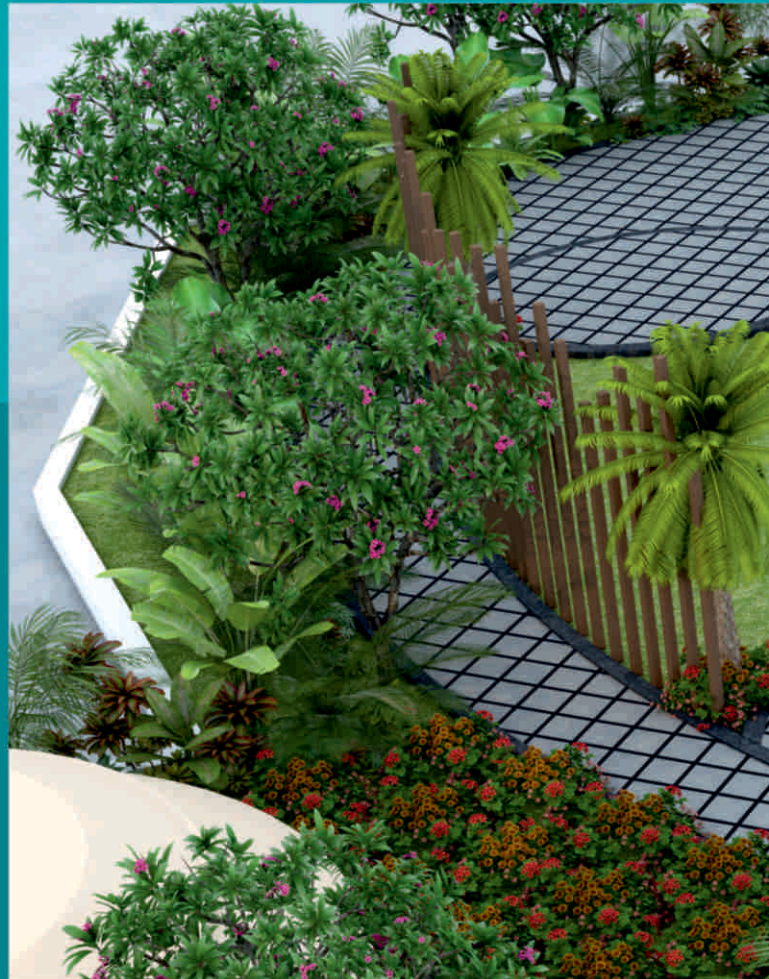

OHSR & CWR WATER TANK



KIDS PLAY AREA



GAZEBO



PLANTER SITTING

PARK VIEW



MODERN PATHWAY

PARK ENTRANCE



FEATURE WALL & SCULPTURE



LOCATION MAP

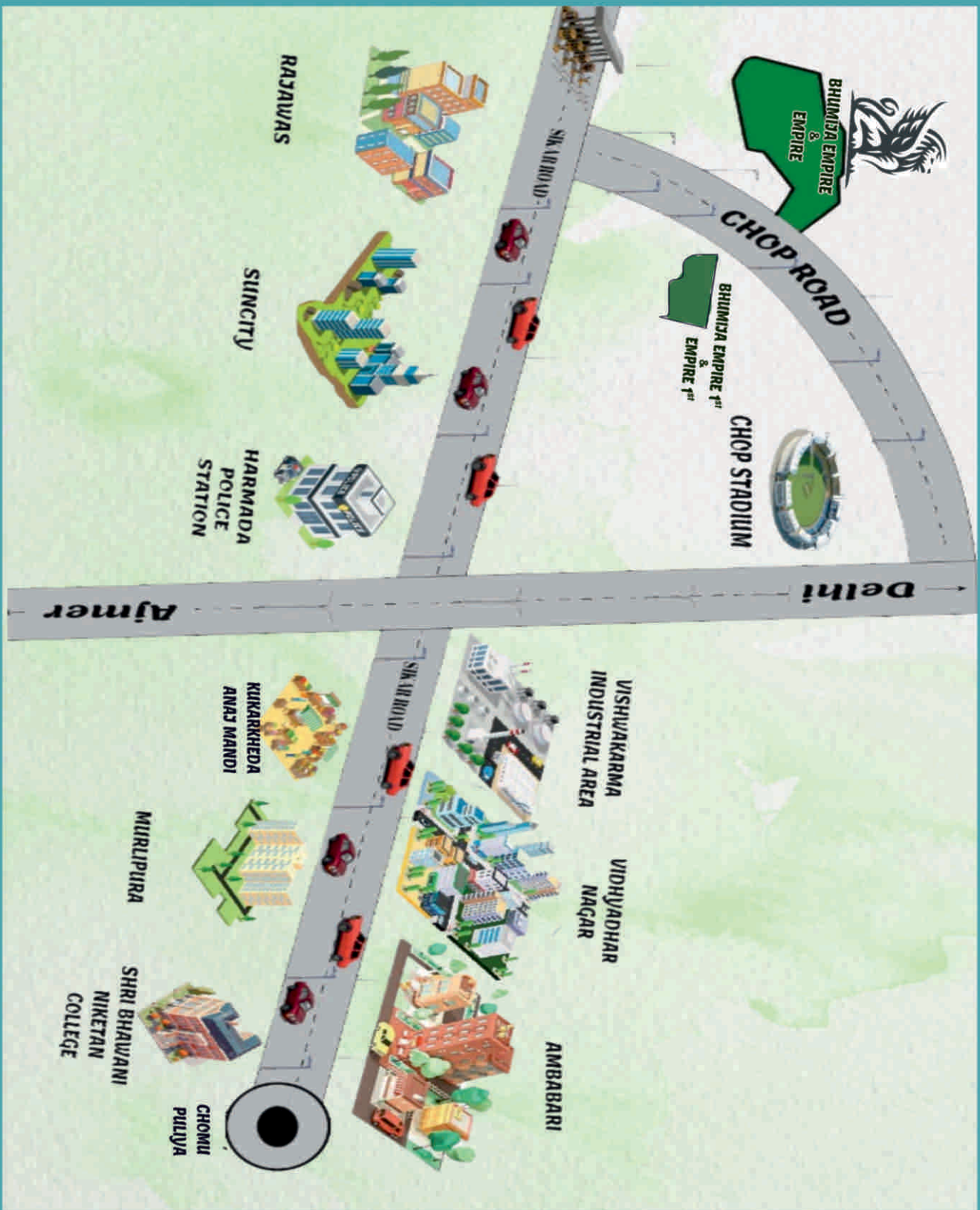

Project by :

GOKULKRIPA BUILDTECH PVT. LTD.

1, SHIV SHANKAR COLONY, MANSAROVAR METRO STATION PILAR NO. 16

KE SAMNE GOPALPURA BYEPASS, MANSAROVAR, JAIPUR